

PRODUCT NO.	DSWBxxLHGGET
ROHS compliant	

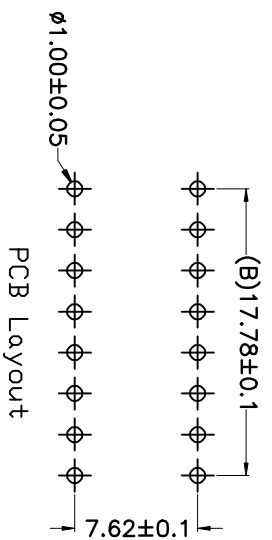
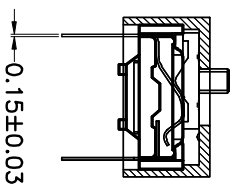
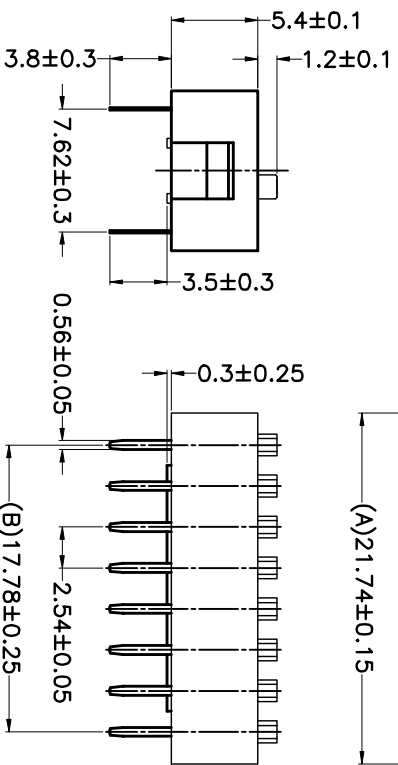
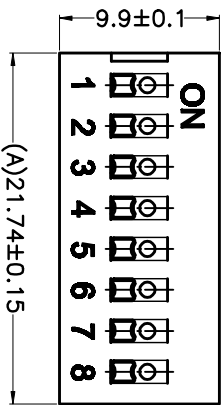

SCHEMATIC(TYP.)  
 ○ ○ ○ ○ ○ ○ ○ ○ ○ ○  
 ○ ○ ○ ○ ○ ○ ○ ○ ○ ○  
 (1,2,3,4,5,6,7,8,9,10,12, POS AVAIL)

PRD. NO.	NO. OF POS.	DIM. A	DIM. B	PRD. NO.	NO. OF POS.	DIM. A	DIM. B
DSWB02LHGGET	2	6.50	2.54	DSWB08LHGGET	8	21.74	17.78
DSWB03LHGGET	3	9.04	5.08	DSWB09LHGGET	9	24.28	20.32
DSWB04LHGGET	4	11.58	7.62	DSWB10LHGGET	10	26.82	22.86
DSWB05LHGGET	5	14.12	10.16	DSWB11LHGGET	11	29.36	25.40
DSWB06LHGGET	6	16.66	12.70	DSWB12LHGGET	12	31.90	27.94
DSWB07LHGGET	7	19.20	15.24				

- Note:
- All dimensions are in millimeters.
  - General tolerance:  $\pm 0.2\text{mm}$ .
  - Material:

Base: UL94V-0 PBT Thermoplastic (Black).  
 Cover: UL94V-0 PBT Thermoplastic (Black/Red/Blue).  
 Actuators: UL94V-0 PA66 Thermoplastic (White).  
 Contact plating: Gold plating over nickel.  
 Pitting material: Epoxy.

4. Electrical  
 Electrical: 2000 Operations per switch 24/VDC, 25mA.  
 Non-Switching Rating: 100mA, 50/VDC.  
 Switching Rating: 25mA, 24/VDC  
 Contact Resistance: 100 mΩ Max at initial.

5. Mechanical  
 Mechanical life: 2000 Operations per switch.  
 Stroke: 2.0mm.  
 Operation Temp: -20°C to 70°C.  
 Storage Temp: -40°C to 85°C.

6. PART NUMBER DESCRIPTION:

DS WB XX L H G G E T

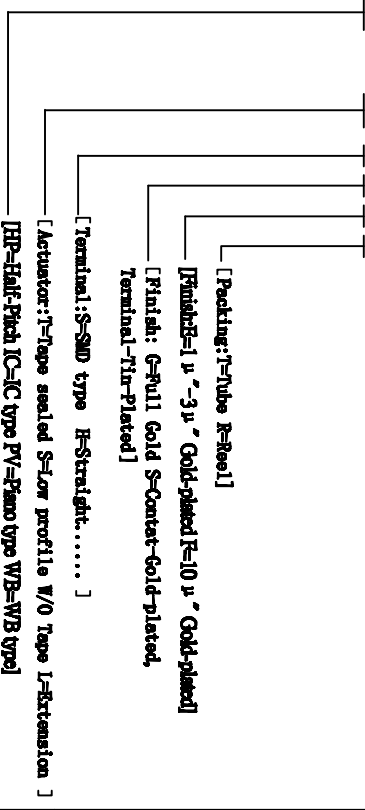

TOLERANCE UNLESS OTHERWISE SPECIFIED	INSPECTION COPY	PROJECTION	TITLE
LINER 0 ± 0.30	ANGLES 0 ± 1°		BY DSWB SERIES PITCH 2.54mm PRODUCT FAMILY DSWB SERIES PRAT NO. DSWBxxLHGGET FILE NO. DSWBxxLHGGET-A SIZE UNIT SCALE SHEET REV. A4 mm FIT 1 OF 1 A
.00 ± 0.20	.0 ± 0.5°		
.000 ± 0.10	.00 ±		
DESIGN LU ER XIN	2013/07/02		
DRAWING			
CHECK			
APPRO.			

东莞市富实业有限公司  
 Dongguan Kingtek Industrial Co., Ltd.