

RoHS

SPECIFICATIONS

Rated Current:1.5AMP

Contact Resistance:20mΩ Max

Withstand Voltage:500V AC/DC

Insulation Resistance:1000MΩ Min

Operation Temperature:-40°C to +105°C

Contact Material:Brass

Contact Plating:Au Over Ni

Insulator Material:Polyester(UL94V-0)

Standard: PA6T

Max.Processing Temp: 230°C for 30-60 seconds
(260°C for 10 seconds)

Recommended P.C.B Layout(Top Side)
(PCB BOARD TOLERANCE±0.05)

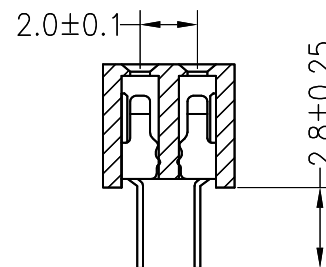
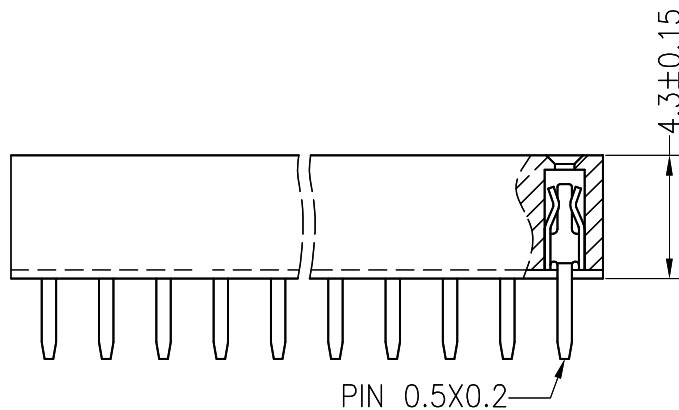
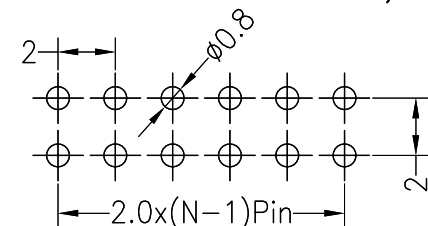
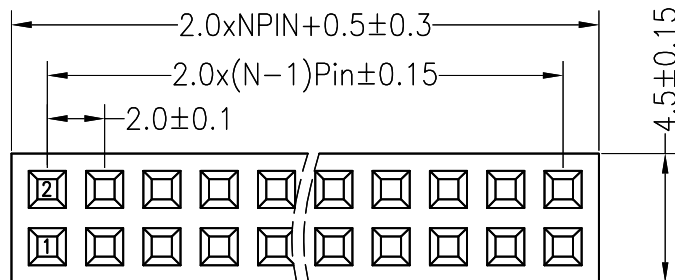

| | | | | | | | | | | | |
|---|-----|------|--------------------------|-----------|-------|---------|---|-------|-----|--|--|
| | | | | OPERATION | | DRAW | | SCALE | FIT | 深圳市连盛精密连接器有限公司 | |
| | | | | X.X | ±0.30 | | | UNIT | mm | | |
| | | | | X.XX | ±0.20 | CHECK | | SIZE | A4 | PART NO. FH-00380 | |
| | | | | X.XXX | ±0.10 | | | SHEET | 1/1 | TITLE: 2.0FH H4.3mm 2x20pin 180° W4.50 PC2.8 | |
| | | | | Angle | ±3° | APPROVE | | PROJ. | ◆ | | |
| | | | | DIM | TOL | | | | | | |
| A | REV | DATE | MODIFICATION DESCRIPTION | CHANGE | | | | | | | |
| | 1 | | 2 | 3 | 4 | 5 | 6 | 7 | 8 | 9 | |