

1 ROHS

2

3

4

Autodesk 教育版产品制作

7

8

9

10

MAPX	MODIFICATION	DATE
------	--------------	------

规格说明: Specifications:

电气特性: Electrical:

1. 额定电流: Current Rating
1.5A/contact terminal
2. 额定电压: Voltage Rating
30V DC
3. 接触阻抗: Contact Resistance
30 milliohms MAX
4. 耐电压: Dielectric Withstanding Voltage:
500 V AC AT Sea Level
5. 绝缘阻抗: Insulation Resistance:
1000MEGA ohms MIN

物理性能: Mechanical:

1. 插拔力: Connector Mate and Umate Force
Mate force: 3.57kgf (MAX)
Umate force: 1.02kgf (MIN)
2. 端子保持力: Terminal Retention
1.2kgf (MIN)

原材料: Material:

1. 塑胶: Housing:
Hing Temperature Thermoplastics,
U1 94V-0 PBT White/Black
2. 端子: Contact: Copper Alloy C2680
3. 外壳: Shell: Copper Alloy C2680/SPCC

电镀: Finish:

1. 端子: Contact: Plated Gold in Mating Area;
Tin On Solder Talls
2. 外壳: Shell:
Nickel Plating

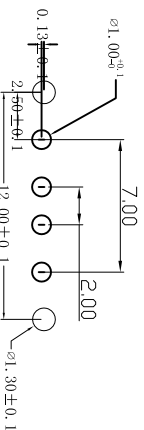
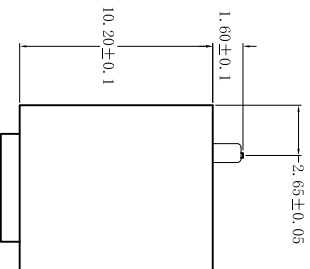
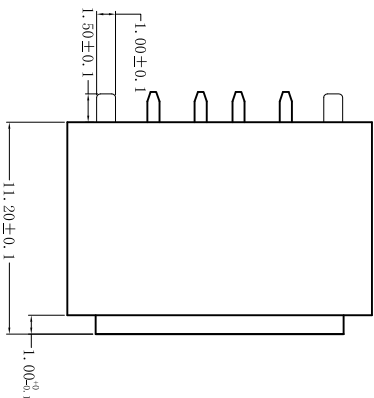
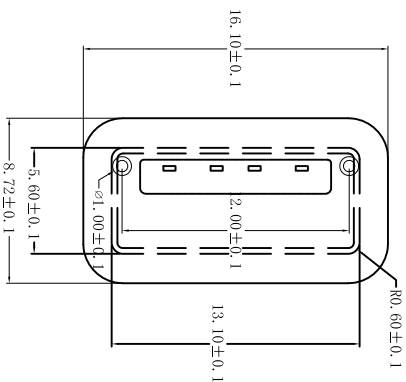

变更说明: 1. 耳朵上的孔, 由直径1.7改为2.0mm

2. 耳朵往尾部方向加胶, 增厚, 平USB端子尾端

3. 尾部加2个定位柱, 大小和位置可变动, 按贵司模具上的方

便为准

变更部分以红线表示

深圳市精拓金电子有限公司

产品图
PRODUCT CHART DWG

公差一览表
TOLERANCE UNLESS OTHERWISE

X	±0.35	X	±5°
X	±0.20	X	±2°
XX	±0.10	XX	±1°
XXX	±0.05	XXX	±0.5°

单位 UNITS	MM	制图 DRAWING	许密强	制料号 PRODUCT PART NO	USB AF 180度DIP防水(无耳)
比例 SCALE	1:1	审核 CHKD	郭治富	产品名称 PRODUCT NO	1.0柱
日期 DATE	2016-09-09	核准 APRD	黄国荣	角法 VIEW	版本 VER
					AD