

目錄 MAPX	變更內容 MODIFICATION	日期 DATE
------------	----------------------	------------

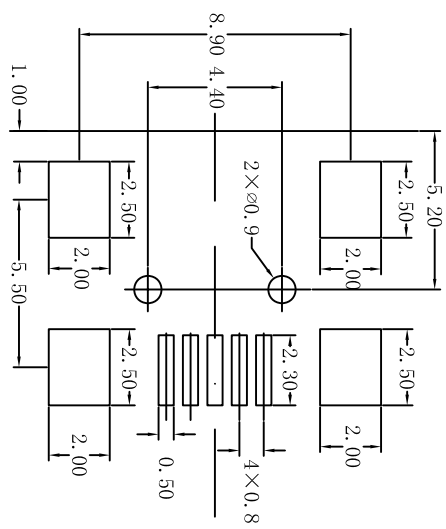
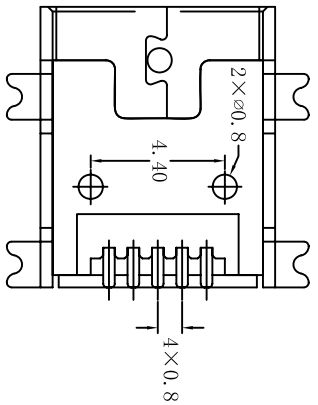
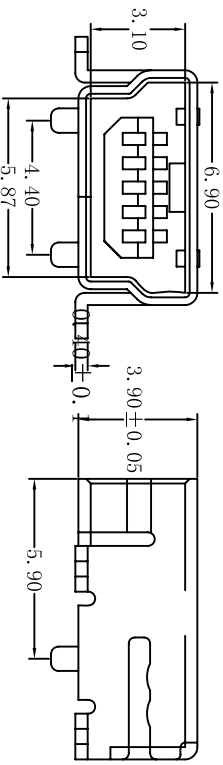
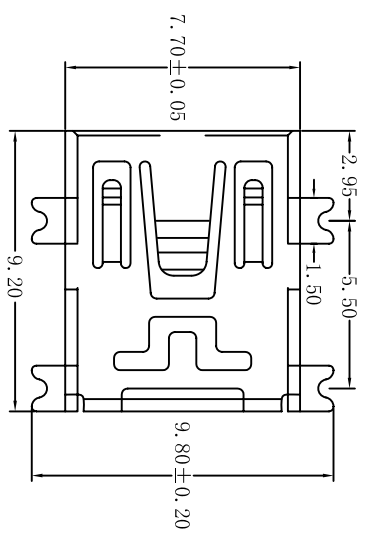

RECOMMENDED PCB LAYOUT

规格说明: Specifications:

电气特性: Electrical:

1. 额定电流: Current Rating  
1.0A/contact terminal
2. 额定电压: Voltage Rating  
30V DC
3. 接触阻抗: Contact Resistance  
50 milliohms MAX
4. 耐电压: Dielectric Withstanding Voltage:  
300 V AC AT Sea Level
5. 绝缘阻抗: Insulation Resistance:  
100MEGA ohms MIN

物理性能: Mechanical:

1. 插拔力: Connector Mate and Unmate Force  
Mate force: 3.0Kgf(MAX)  
Unmate force: 0.7Kgf(MIN)
2. 端子保持力: Terminal Retention  
0.5Kgf(MIN)

原材料: Material:

1. 塑胶: Material:  
Hing Temperature Thermoplastics,  
Ul 94V-0 LCP Black
  2. 端子: Contact: Copper Alloy C2680/C5191
  3. 外壳: Shell: Copper Alloy C2680
- 电镀: Finish:  
1. 端子: Contact: Plated Gold in Mating Area:  
Tin On Solder Tails  
2. 外壳: Shell:  
Nickel Plating

产品图  
PRODUCT CHART DWG

深圳市精拓金电子有限公司

公差一览表 TOLERANCE UNLESS OTHERWISE		单位 UNITS	MM	制图 DRAWING	产品料号 PRODUCT PART NO.
X	±0.25	X'	±5'	审核 CHECK	产品名称 PRODUCT NAME (B型1.0针)
.X	±0.20	.X'	±2'	核准 APPRO	MINI USB 5P/P SMT
.XX	±0.15	.XX'	±1'	日期 DATE	角法 VIEW
.XXX	±0.10	.XXX'	±0.5'	2014/10/20	版本 VERS

