

RoHS

SPECIFICATIONS

Rated Current:1.5AMP
 Contact Resistance:20mΩ Max
 Withstand Voltage:500V AC/DC
 Insulation Resistance:1000MΩ Min
 Operation Temperature:-40°c to +105°c

Contact Material:Brass
 Contact Plating:Au Over Ni
 Insulator Material:Polyester(UL94V-0)
 Standard: PA6T
 Max.Processing Temp: 230°C for 30-60 seconds
 (260°C for 5 seconds)

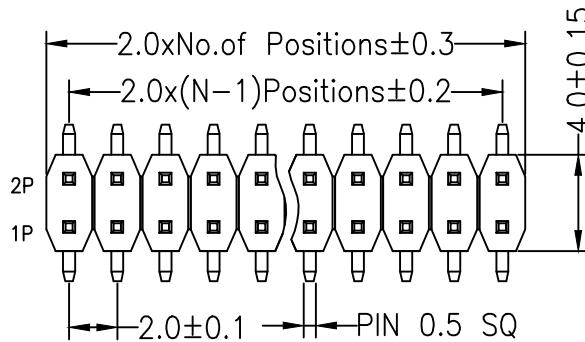

Recommended P.C.B Layout(Top Side)
 (PCB BOARD TOLERANCE ± 0.05)

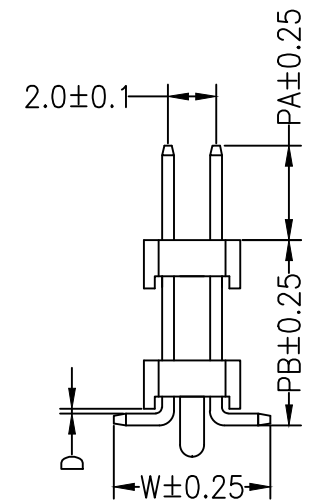
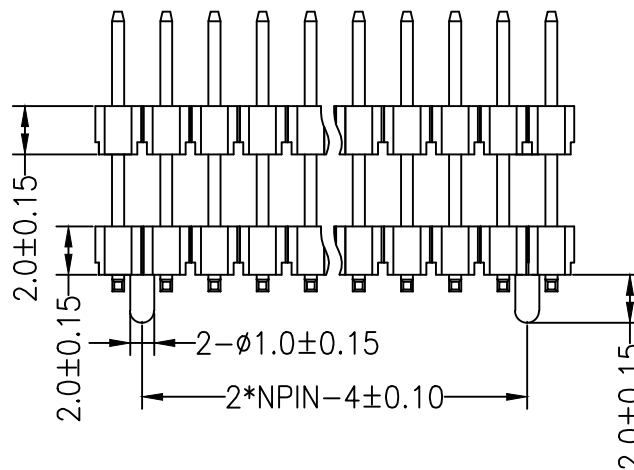
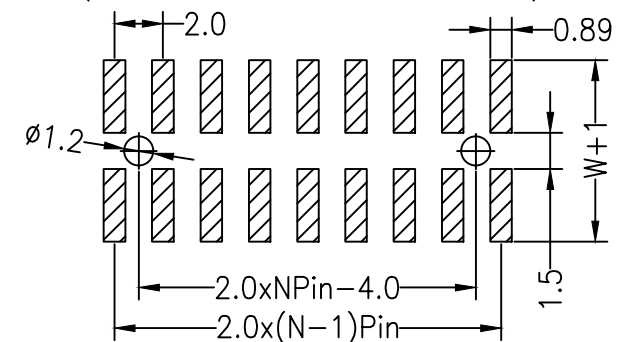

W= With Post

Dimension antitheses list					
ITEM	PA	D	PB	W	L
Alternate	5.30	0.00	11.20	6.50	18.20
Alternate					

REV	DATE	MODIFICATION DESCRIPTION	CHANGE	OPERATION		DRAW	SCALE	FIT
				DIM	TOL			
A0	2012.04.11	NEW DRAWING		X.X	± 0.30		UNIT	mm
				X.XX	± 0.20	CHECK	SIZE	A4
				X.XXX	± 0.10		SHEET	1/1
				Angle	$\pm 3'$	APPROVE	PROJ.	ϕ \perp

深圳市连盛精密连接器有限公司	
PART NO.	PH-00994
TITLE:	2.0PH 双塑 2x11pin SMT 带柱